

2019 ALANTE



2019 ALANTE



**2**  
YEAR  
LIMITED  
WARRANTY

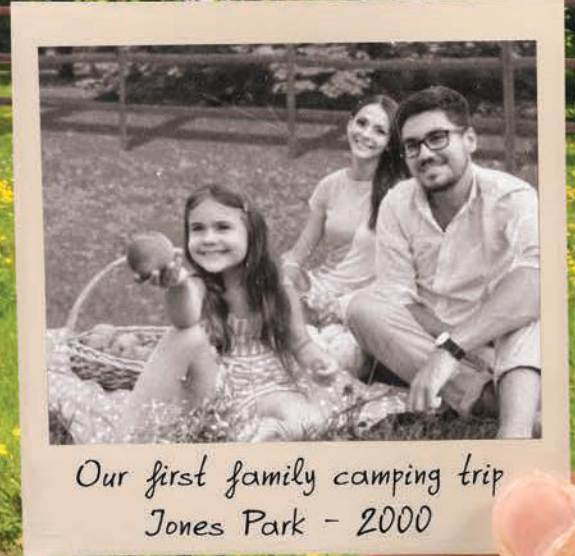

Our first family camping trip  
Jones Park - 2000



## ALANTE

### FEATURED FLOORPLAN 26X:

- 6-WAY POWER DRIVER SEAT
- SOUNDSTREAM INFOTAINMENT SYSTEM WITH GPS
- RECESSED LED LIGHTS THROUGHOUT
- STAINLESS STEEL SINKS
- HARDWOOD CABINET DOORS
- OPTIONAL DROP-DOWN BUNK WITH 750LB CAPACITY

## ALANTE EXTERIOR



SPARKLING SAND GRAPHICS

## ALANTE INTERIOR DÉCOR SELECTIONS

### ALBANY



SOFA/DINETTE

DINETTE ACCENT

ACCENT

BEDSPREAD

BEDROOM ACCENT

### NANTUCKET



SOFA/DINETTE

DINETTE ACCENT

ACCENT

BEDSPREAD

BEDROOM ACCENT

# ALANTE FLOORPLANS

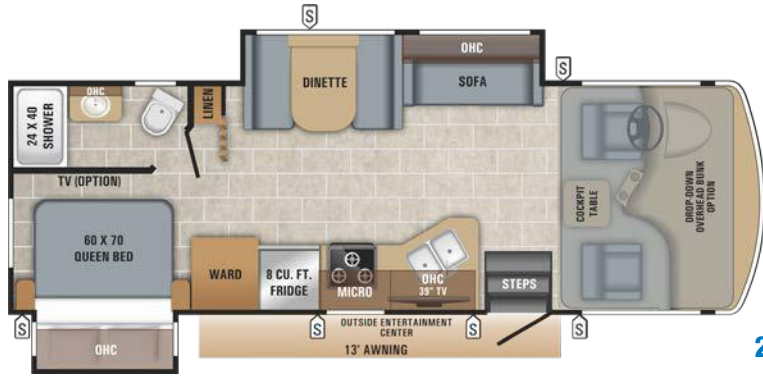

26X

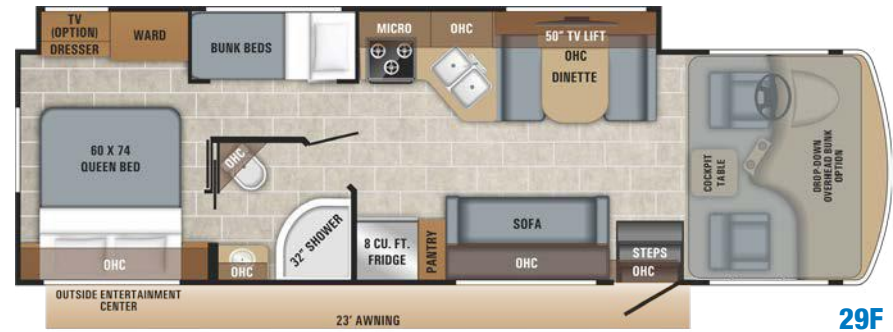

29F

OPTION: A, B

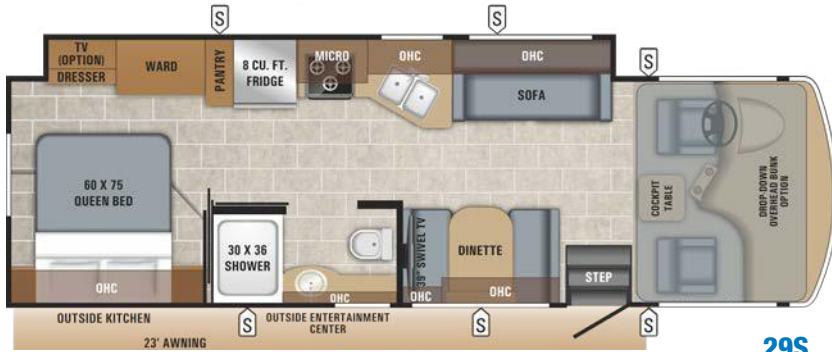

29S

OPTION: A, B



31R

OPTION: B



31V

OPTION: A, B

## OPTIONS:



THEATER SOFA

A



12 CU FT

FRIDGE

B

## SPECS

MODELS	DIMENSIONS					TANKS (GALS.)			
	FLOORPLAN	EXTERIOR LENGTH	EXTERIOR WIDTH	EXTERIOR HEIGHT (WITH A/C)	INTERIOR HEIGHT	WHEEL BASE	FRESH WATER CAPACITY (INCLUDES WATER HEATER)	GREY WASTE WATER CAPACITY	BLACK WASTE WATER CAPACITY
26X		28'	101"	12' 5"	84"	178"	53	40	32
29F		TBD	101"	12' 5"	84"	TBD	TBD	TBD	TBD
29S		31' 4"	101"	12' 5"	84"	190"	72	49	50
31R		34' 5"	101"	12' 5"	84"	228"	72	40	50
31V		32' 1"	101"	12' 5"	84"	190"	72	40	50

**Gross Vehicle Weight Rating (GVWR):** The maximum permissible weight of the motorhome, including the Unloaded Vehicle Weight (UVW) plus passengers, personal items, all cargo, fluids, options and dealer-installed accessories. The GVWR is equal to or greater than the sum of the UVW and the Cargo Carrying Capacity.

**Gross Combined Weight Rating (GCWR):** The maximum allowable combined weight of the motorhome used as a tow vehicle and the attached towed vehicle. It is important for your safety and enjoyment that you are aware of the weights and tow ratings of the RV you select.

Consult a competent advisor for questions or advice. Whether you are new to RVing or a veteran, get a feel for the performance of your RV before heading out on the roadways. When you tow a vehicle with your RV, you must drive differently than when you drive a single vehicle. Practice hooking up, driving, backing up and braking in a safe environment or seek out professional instruction. Jayco affixes a weight label to each RV which lists weight information for that vehicle. Refer to that label to verify the vehicle will meet your requirements.



## THE JAYCO DIFFERENCE

- 1. 120-inch panoramic windshield** equipped with oversized wiper blades to allow for maximum visibility
- 2. Exterior entertainment center** comes standard with an LED TV mounted on a swivel bracket
- 3. One-piece seamless fiberglass roof** offers unmatched durability
- 4. Lockable pass-through storage** with easy-to-use Slam-latch™ doors
- 5. Seatbelts in every seating position** secure the most precious cargo
- 6. Frameless windows** make exterior maintenance easier than ever and give the unit a sleek modern look



To see a full list of standards and options, use your camera app to scan code.



JRide® is a powerful blend of precise handling and renowned stability. Hands down, it's the best ride.

**Experience JRide for yourself—visit your local dealer and take a test drive.**



Use your camera app to scan code and learn more!

### COMPUTER-BALANCED DRIVESHAFT

Ensures smooth and efficient power transfer from the engine to the wheels

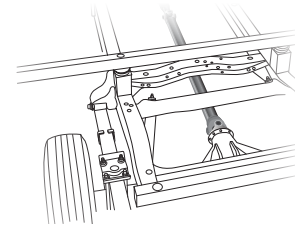

### STANDARD FRONT AND REAR STABILIZER BARS

Reduces the body roll of a vehicle during fast cornering or over road irregularities

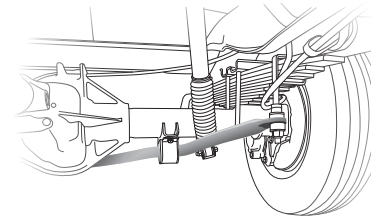

### JOUNCE BUMPERS

Assist during extreme road occurrences to absorb impact and dampen excess road noise

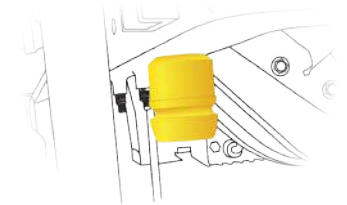

### SACHS SHOCK ABSORBERS

Large-diameter tube design pairs gas and hydraulics to resist heat and pressure while independently adjusting to changing road conditions

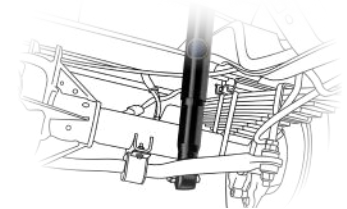

Meet your Jayco Dealer



Follow Jayco  
#Jayco50



Jayco, Inc. | P.O. Box 460 | Middlebury, IN 46540 © RVIA See dealer for further information and prices. All information in this brochure and on www.jayco.com is the latest available at the time of publication approval. Jayco reserves the right to make changes and to discontinue models without notice or obligation. Photography may show optional equipment or props used for decoration purposes only. RVs built for sale in Canada may differ to conform to Canadian codes. JAYCO and the JAYCO BIRD IN FLIGHT are registered trademarks of Jayco, Inc. Printed in USA 36K 7/18 © 2018 Jayco, Inc. 274894

Travel with Confidence



At Jayco, we build our RVs to handle every adventure, then back them with our industry-leading 2-year limited warranty. We, with support from our select partners, have you covered for **2 camping seasons or twenty-four thousand (24,000) miles** (mileage limitation applies to motorized products only), whichever occurs first, from the original date of purchase. You won't find a better warranty in the business, because the only strings we attach are those that deliver the ultimate in reliability. That's the Jayco difference. So go explore. For a copy of our 2-year limited warranty with complete terms and conditions, please contact your local Jayco dealer.



A year's access to Coach-Net™—the country's largest RV emergency road service.

